

# CE-45 Series

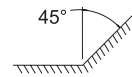

## End Mills

0° Pos Axial 0° Pos Radial 45° Lead

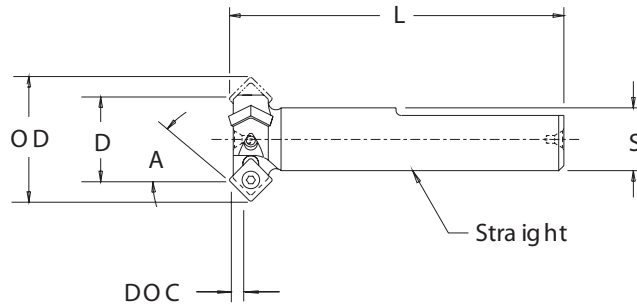
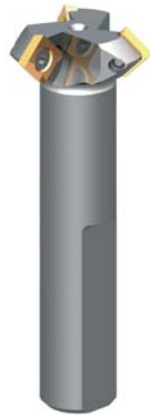



• 45° Chamfer Cutter

### CE-45 Series - Dimensional Specifications

Product Number	D	OD	S	L	A	DOC	Insert	Teeth	Weight
1.00CE45RW2.5	0.49	1.00	.625	4.00	45°	*	SPEB-32__	1	.33
1.50CE45RW3	0.99	1.50	.750	4.00	45°	*	SPEB-32__	3	.75
2.00CE45RW4	1.49	2.00	1.000	5.00	45°	*	SPEB-32__	4	1.00

**LEFT HAND cutters also available**

Insert I.C. x Thickness	 Insert Pg. 41	 Insert Screw	 Insert Screw Wrench
.375 x .126	SPEB-32__	3605-0001-0005	1557-TX10

NOTE:  
Actual Insert Flats:  
\* .221 with SPEB-322  
\* .244 with SPEB-321

### Machining Parameters

Material	SFPM	FPT	Primary	Secondary
Gray Cast Iron, Class 30	200-500	.003-.010	SPEB-321J GR LTC-10	SPEB-321B GR LT-50
Tool Steel, D2	250-350	.003-.010	SPEB-321B GR LT-50	SPEB-321 GR LTC-14
Ductile Iron	300-700	.003-.010	SPEB-321B GR LT-50	SPEB-321 GR LTC-14
Medium Alloy Steel	300-700	.003-.010	SPEB-321 GR LTC-14	SPEB-321B GR LT-50
Soft Alloy Steel	400-800	.003-.010	SPEB-321 GR LTC-14	SPEB-321B GR LT-50

- Engineered for free cutting chamfering cuts on a variety of workpiece materials
- Multifunction design allows CE-45 to plunge or produce peripheral cuts
- Simple screw on insert design provides quick accurate indexing
- Small shank diameters accommodate a broad range of machine tool types