

Inserts

Silicon Nitride

CNG Type

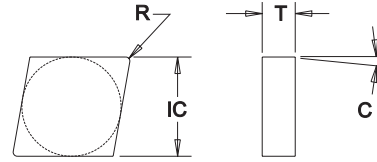
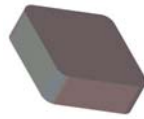

Silicon Nitride Insert Dimensional & Grade Specifications

Insert Number	IC	T	R	C	Silicon Nitride		
					Edge Preparation	LTC-1000	LTC-1200
CNG-433W820	0.500	0.188	0.047	0°	8° X .020		
CNG-434W820	0.500	0.188	0.062	0°	8° X .020		
CNG-443W820	0.500	0.250	0.047	0°	8° X .020		
CNG-444W820	0.500	0.250	0.062	0°	8° X .020		
CNG-533W820	0.625	0.188	0.047	0°	8° X .020		
CNG-534W820	0.625	0.188	0.062	0°	8° X .020		
CNG-543W820	0.625	0.250	0.047	0°	8° X .020		
CNG-544W820	0.625	0.250	0.062	0°	8° X .020		
CNG-633W820	0.750	0.188	0.047	0°	8° X .020		
CNG-634W820	0.750	0.188	0.062	0°	8° X .020		

RNG Type

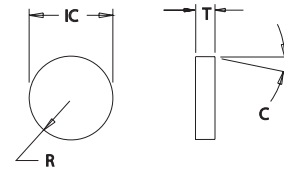

Silicon Nitride Insert Dimensional & Grade Specifications

Insert Number	IC	T	R	C	Silicon Nitride		
					Edge Preparation	LTC-1000	LTC-1200
RNG-43W820	0.500	0.188	0.250	0°	8° X .020		
RNG-53W820	0.625	0.188	0.312	0°	8° X .020		
RNG-63W820	0.750	0.188	0.375	0°	8° X .020		

RPC Type

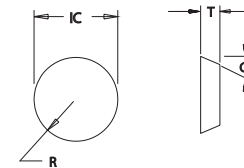

Silicon Nitride Insert Dimensional & Grade Specifications

Insert Number	IC	T	R	C	Silicon Nitride		
					Edge Preparation	LTC-1000	LTC-1200
RPC-43W630	0.500	0.188	0.250	11°	6° X .030		
RPC-53W630	0.625	0.188	0.312	11°	6° X .030		
RPC-63W630	0.750	0.188	0.375	11°	6° X .030		

- All Materials
- Cast Iron
- Hardened Materials
- Steel
- Aluminum / Non-Ferrous
- Stainless Steel
- Heat Resistant Super Alloys