

HPM Series

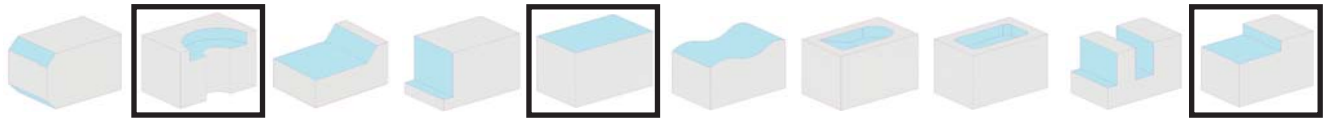

End Mills

10° Pos Axial

Pos Radial

90° Shoulder

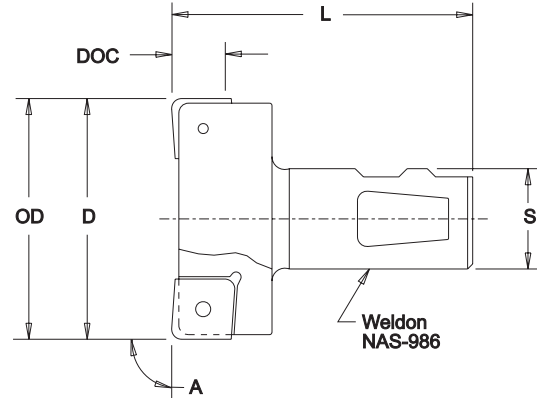

• Dynamically balanced for 3,000 sfpm

HPM Series - Dimensional Specifications

Product Number	D	OD	S	L	A	DOC	Insert	Teeth	Max. Recommended RPM	Weight
2.5HPMRWA5	2.50	2.50	1.25	3.75	90°	.625	MECA-63__J	2	4500	1.70
3.0HPMRWA5	3.00	3.00	1.25	3.75	90°	.625	MECA-63__J	2	4000	2.50
3.5HPMRWA5	3.50	3.50	1.25	3.75	90°	.625	MECA-63__J	2	3500	3.40
4.0HPMRWA5	4.00	4.00	1.25	3.75	90°	.625	MECA-63__J	2	3000	4.50
6.0HPMRWA5	6.00	6.00	1.25	3.75	90°	.625	MECA-63__J	2	2000	10.00

LEFT HAND cutters also available

Insert I.C. x Thickness					
	Insert Pg. 37	Insert Lock	Lock Screw	Spring Pin	Lock Screw Wrench
.750 x .188	MECA-63__J	1619PF	1452	1/8 x 3/8	1557-PT10
	"J" Polish				

Machining Parameters

Material	SFPM	FPT	Primary	Secondary
Aluminum and Aluminum Alloy	1000 & Up	.005-.020	MECA-63__J GR LTC-21	N/A

- Dynamically balanced for 3,000 sfpm for high velocity milling of aluminum
- Security *Safe-Plus™* locking system ensures operator safety in extreme applications
- Coarse pitch design accommodates heavy feed rates with excellent chip evacuation
- "J" polished MECA type inserts create smooth clean cutting action on all soft materials
- Combination NAS-986 weldon shank can be used in most machine tool types



Index

Specials

Inserts

General

Cavity Mold

Gray Iron

PCD / CBN

Slotters

Technical Data

Holders