

LSM Series

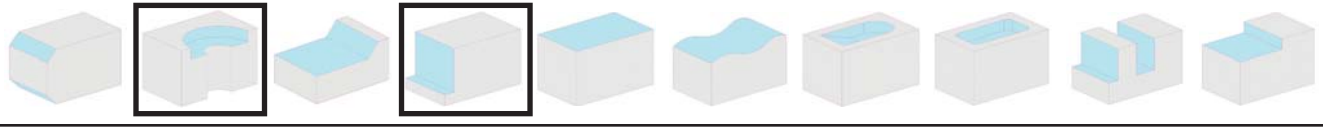

End Mills

7° Pos Axial Neg Radial 90° Shldr -to 2.00 dia
 7° Pos Axial Pos Radial 90° Shldr -2.50 & up

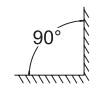
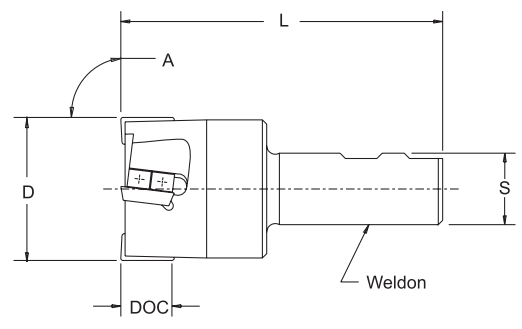

• High Performance - Deep Shoulder Cutting - General Purpose Tooling

LSM Series - Dimensional Specifications

Product Number	D	S	L	A	DOC	Insert	Screw	Teeth	Weight
1.25LSMRW4	1.25	1.00	4.50	90°	.960	KDE-343_R CKDE-343_R	3601-0001-0017	3	1.00
1.50LSMRW4	1.50	1.00	4.50	90°	.960	KDE-343_R CKDE-343_R	3601-0001-0017	3	1.25
2.00LSMRW4	2.00	1.00	4.50	90°	.960	KDE-343_R CKDE-343_R	1449	4	2.00
2.50LSMRW4	2.50	1.00	4.50	90°	.960	KDE-343_R CKDE-343_R	1449	6	2.50
3.00LSMRW4	3.00	1.00	4.50	90°	.960	KDE-343_R CKDE-343_R	1449	6	3.00

LEFT HAND cutters also available

Insert I.C. x Thickness					
.375 x .188	Insert Pg. 35 KDE-343_R	Insert Pg. 31 CKDE-343_R	Insert Lock 1602	Lock Screw 3601-0001-0017 1449	Lock Screw Wrench 1557-PT6

Machining Parameters

Material	SFPM	FPT	Primary	Secondary
Stainless Steel 302,304, 316	250-450	.003-.010	KDE-3432R GR LT-45	KDE-3432R GR LTC-10
Soft Alloy Steel	400-800	.003-.010	KDE-3432RA GR LT-40	KDE-3432R GR LTC-14

- Positive/Negative geometry accommodates a variety of workpiece materials
- Engineered for stability during deep peripheral or channel cuts
- True 90° shoulders can be generated using the optional CKDE style insert
- CKDE and KDE type inserts provide outstanding DOC to diameter ratios
- Standard 1.00" shanks make LSM ideal for use on all light duty machine tools

