

# NXSM Series

( for Flat Bottom Only )

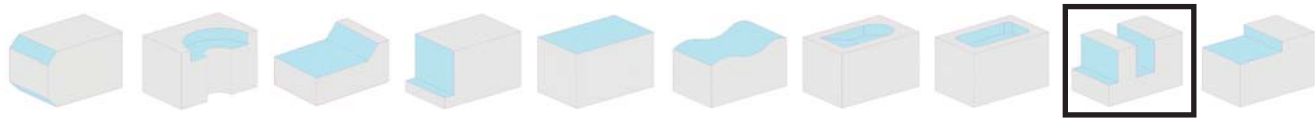

## Slotting Cutter .750 Insert



• Adjustable Widths

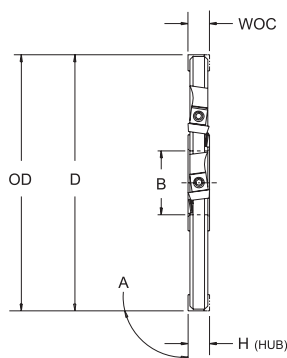

7° Pos Axial   Pos Radial   90° Shldr

• NXSM uses .750 FPE insert for true flat bottom ONLY!

### NXSM Series - Dimensional Specifications

Product Number	D	OD	B	H	A	WOC	Insert	Teeth	Weight
5NXSM13-6H	5.00	5.00	1.50	.812	90°	.812-.875	FPE-63__	10	3.00
6NXSM13-6H	6.00	6.00	1.50	.812	90°	.812-.875	FPE-63__	12	4.30
8NXSM13-8H	8.00	8.00	2.00	.812	90°	.812-.875	FPE-63__	16	8.00
10NXSM13-8H	10.00	10.00	2.00	.812	90°	.812-.875	FPE-63__	20	12.00
12NXSM13-10H	12.00	12.00	2.50	.812	90°	.812-.875	FPE-63__	24	18.00
5NXSM14-6H	5.00	5.00	1.50	.875	90°	.875-1.000	FPE-63__	10	3.30
6NXSM14-6H	6.00	6.00	1.50	.875	90°	.875-1.000	FPE-63__	12	4.50
8NXSM14-8H	8.00	8.00	2.00	.875	90°	.875-1.000	FPE-63__	16	9.00
10NXSM14-8H	10.00	10.00	2.00	.875	90°	.875-1.000	FPE-63__	20	15.00
12NXSM14-10H	12.00	12.00	2.50	.875	90°	.875-1.000	FPE-63__	24	21.00
5NXSM16-6H	5.00	5.00	1.50	1.000	90°	1.000-1.125	FPE-63__	10	3.50
6NXSM16-6H	6.00	6.00	1.50	1.000	90°	1.000-1.125	FPE-63__	12	5.50
8NXSM16-8H	8.00	8.00	2.00	1.000	90°	1.000-1.125	FPE-63__	16	10.00
10NXSM16-8H	10.00	10.00	2.00	1.000	90°	1.000-1.125	FPE-63__	20	17.00
12NXSM16-10H	12.00	12.00	2.50	1.000	90°	1.000-1.125	FPE-63__	24	24.00
5NXSM18-6H	5.00	5.00	1.50	1.125	90°	1.125-1.250	FPE-63__	10	3.80
6NXSM18-6H	6.00	6.00	1.50	1.125	90°	1.125-1.250	FPE-63__	12	6.50
8NXSM18-8H	8.00	8.00	2.00	1.125	90°	1.125-1.250	FPE-63__	16	11.00
10NXSM18-8H	10.00	10.00	2.00	1.125	90°	1.125-1.250	FPE-63__	20	19.00
12NXSM18-10H	12.00	12.00	2.50	1.125	90°	1.125-1.250	FPE-63__	24	27.00
5NXSM20-6H	5.00	5.00	1.50	1.250	90°	1.250-1.375	FPE-63__	10	4.00
6NXSM20-6H	6.00	6.00	1.50	1.250	90°	1.250-1.375	FPE-63__	12	7.50
8NXSM20-6H	8.00	8.00	2.00	1.250	90°	1.250-1.375	FPE-63__	16	12.00
10NXSM20-8H	10.00	10.00	2.00	1.250	90°	1.250-1.375	FPE-63__	20	21.00

Insert I.C. x Thickness					
.750 x .188	Insert Pg. 34 FPE-63__	Insert Lock 1619	Lock Screw 1450	Adjusting Screw 1367	Lock Screw Wrench 1557-PT10

### Machining Parameters

Material	SFPM	FPT	Primary	Secondary
Gray Cast Iron, Class 30	200-500	.002-.008	FPE-634 GR LTC-21	FPE-634 GR LTC-83
Tool Steel, D2	250-350	.002-.008	FPE-634W515 GR LT-40	FPE-634W515 GR LT-40
Medium Alloy Steel	300-700	.002-.008	FPE-634W515 GR LT-40	FPE-634B GR LTC-37
Tool Steel, P20	300-700	.002-.008	FPE-634W515 GR LT-40	FPE-634 GR LTC-14
Soft Alloy Steel	400-800	.002-.008	FPE-634 GR LTC-14	FPE-634 GR LTC-14

- Free cutting positive geometry designed for a broad range of workpiece materials
- High production design includes offset drive keys for multiple tool “gang” setups
- Engineered with generous chip gullets to ensure optimum chip evacuation
- Adjustable widths ensure infinite coverage between .812” and 1.375” in each NXSM diameter
- Engineered for stability over a variety of applications



Index

Specials

Inserts

General

Cavity Mold

Gray Iron

PCD / CBN

Slotters

Technical Data

Holders